

INVERTED VENT CHECK VALVES

PART NUMBER			OUTSIDE SIZE/NPT	OVERALL DIAMETER	LENGTH
ALUMINUM	CAST IRON	BRONZE			
20ACV150	53ICV150	00BCV150	1½"	3 ⁷ / ₁₆ "	5¼"
20ACV200	53ICV200	00BCV200	2"	4 ¹ / ₈ "	6"
20ACV250	53ICV250	00BCV250	2½"	4 ⁷ / ₈ "	7"
20ACV300	53ICV300	00BCV300	3"	5½"	8 ³ / ₈ "
20ACV400	53ICV400	00BCV400	4"	7 ¹ / ₈ "	9½"
20ACV500	53ICV500	00BCV500	5"	8 ³ / ₄ "	10 ⁵ / ₈ "
20ACV600	53ICV600	00BCV600	6"	10 ⁷ / ₈ "	11 ³ / ₈ "



Venting improves the efficiency of loading and unloading cargo by eliminating dangerous pressure or vacuum buildup. Inverted Vent Check Valves add a measure of security, preventing deck wash, deck fire and debris from traveling through the vent.

STANDARD COMPONENTS

SIZE	MATERIAL	FLOAT	PART NUMBERS			
			FLOAT STOP	FIRE SCREEN	DEBRIS SCREEN	RETAINING RING
1½"	BRONZE	00CV150CF	00BCV150FS	70CV150FS	3BCV150SDS	00BCV150RR
2"	BRONZE	00CV200CF	00BCV200FS	70CV200FS	3BCV200SDS	00BCV200RR
2½"	BRONZE	00CV250CF	00BCV250FS	70CV250FS	3BCV250SDS	00BCV250RR
3"	BRONZE	00CV300CF	00BCV300FS	70CV300FS	3BCV300SDS	00BCV300RR
4"	BRONZE	00CV400CF	00BCV400FS	70CV400FS	3BCV400SDS	00BCV400RR
5"	BRONZE	00CV500CF	00BCV500FS	70CV500FS	3BCV500SDS	00BCV500RR
6"	BRONZE	00CV600CF	00BCV600FS	70CV600FS	3BCV600SDS	00BCV600RR
1½"	IRON	00CV150CF	53 ICV150FS	70CV150FS	3BCV150SDS	53 ICV150RR
2"	IRON	00CV200CF	53 ICV200FS	70CV200FS	3BCV200SDS	53 ICV200RR
2½"	IRON	00CV250CF	53 ICV250FS	70CV250FS	3BCV250SDS	53 ICV250RR
3"	IRON	00CV300CF	53 ICV300FS	70CV300FS	3BCV300SDS	53 ICV300RR
4"	IRON	00CV400CF	53 ICV400FS	70CV400FS	3BCV400SDS	53 ICV400RR
5"	IRON	00CV500CF	53 ICV500FS	70CV500FS	3BCV500SDS	53 ICV500RR
6"	IRON	00CV600CF	53 ICV600FS	70CV600FS	3BCV600SDS	53 ICV600RR
1½"	ALUMINUM	70ACV150SF	20ACV150FS	70CV150FS	70CV150SDS	70ACV150RR
2"	ALUMINUM	70ACV200SF	20ACV200FS	70CV200FS	70CV200SDS	70ACV200RR
2½"	ALUMINUM	70ACV250SF	20ACV250FS	70CV250FS	70CV250SDS	70ACV250RR
3"	ALUMINUM	70ACV300SF	20ACV300FS	70CV300FS	70CV300SDS	70ACV300RR
4"	ALUMINUM	70ACV400SF	20ACV400FS	70CV400FS	70CV400SDS	70ACV400RR
5"	ALUMINUM	70ACV500SF	20ACV500FS	70CV500FS	70CV500SDS	70ACV500RR
6"	ALUMINUM	70ACV600SF	20ACV600FS	70CV600FS	70CV600SDS	70ACV600RR

FLOAT:

Spun Copper standard, other float material priced on request

FLOAT STOP:

Precision cast to locate the ball

FIRE SCREEN:

Stainless Steel fine mesh

GALVANIZED DEBRIS SCREEN:

Rugged coarse openings

WAGER



Inverted Vent Check Valve Model 1750

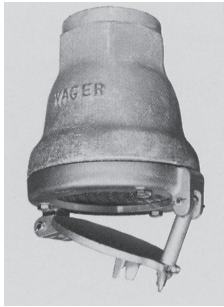

Description: Model 1750 Wager Inverted Vent Check Valves consist of a body, (Steel, Stainless Steel, Cast Iron, Bronze or Aluminum), ball float, valve seat, fine flame screen and heavy protective mesh and cover. Connections are either screwed I PS, flanged ASA, or weld type as required.

The general design utilizes a ball float which in the normally open position rests at the bottom of the assembly on the float support ring. A wash or submerging of the valve will float the ball upwards, positioned by the guides to seat in a machined insert seat at top of body which closes the valve during the period of submergence, after which it automatically falls to the open position.

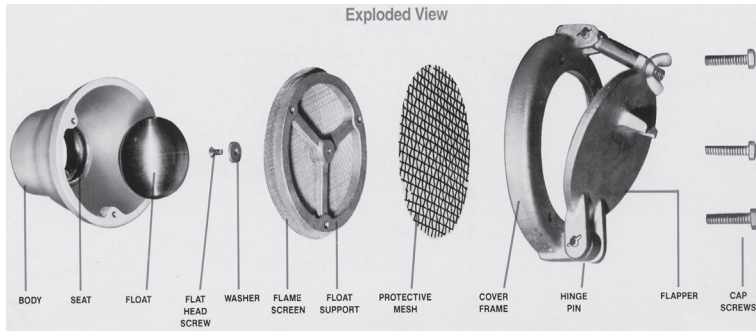

Function: Wager Inverted Vent Check Valves protect tanks and bulkheads from vacuum and pressure build-up during loading and unloading of liquid or dry cargo and assures maximum efficiency during pumping operations. The ball float prevents contamination of tank fluids or dry cargo by sea water during heavy seas. The fine stainless steel flame screen protects tank fluids or dry cargo dust from igniting when subject to deck fires. The protective mesh covers the fine flame screen and prevents any mechanical damage from floating objects in the sea water.

Features:

- 1- OPEN AREA RATIO: Meets latest requirements of ABS, USMA, USCG, and NAVY.
- 2- ACCESSIBILITY OF PARTS: Removal of four or six cap screws (depending on size) facilitates cleaning, inspection and/or replacement.
- 3- POSITIVE SEALING: Machined seat assures positive seal when float is in top position.
- 4 - FLOAT: Copper standard, monel, stainless steel, high density polyethylene available.
- 5 - FLOAT SUPPORT: Assures centering of float in open position. Prevents wear on float and screen assembly.
- 6-COVER: Held open and closed with one toggle bolt.
- 7-BODY MATERIAL: Steel, Cast Iron, Bronze, Stainless Steel, or Aluminum.

Flanged Type 1750-F

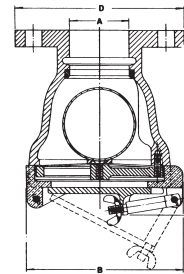

A	1-1/2	2	2-1/2	3	3-1/2	4
B	4-11/16	5-11/32	6-1/4	7-1/8	7-13/16	7-13/16
C	6	6-15/16	7-13/32	8-3/8	9-5/8	9-5/8
D	5	6	7	7-1/2	8-1/2	9
Wt.	10	16	21	28	35	36

Weld Type 1750-W

A	1-1/2	2	2-1/2	3	3-1/2	4
B	4-11/16	5-11/32	6-1/4	7-1/8	7-13/16	7-13/16
C	6	6-15/16	7-13/32	8-3/8	11-1/4	9-5/8
Wt.	7	10	13	20	25	25

Threaded Type 1750-T

A	1-1/2	2	2-1/2	3	3-1/2	4
B	4-11/16	5-11/32	6-1/4	7-1/8	—	7-13/16
C	6	6-15/16	7-13/32	8-3/8	—	9-5/8
Wt.	7	10	13	20	—	25

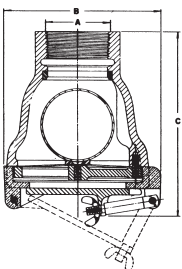
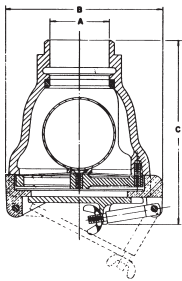

Vertical Vent Check Valve

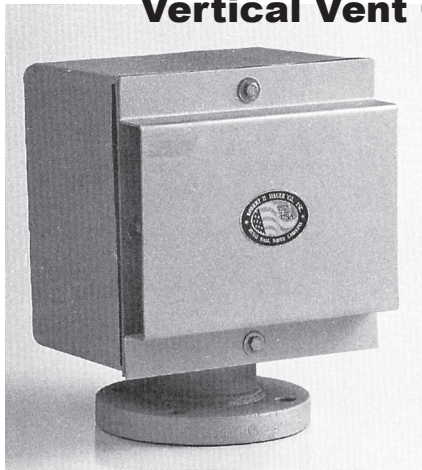

Vertical Vent Check Valve (closed)

WAGER

Function

The Vertical Vent Check Valve is a “normally open” check valve. In heavy seas, any deck washover will push the float to the closed position, stopping water from entering the lower bulkheads.

To prevent a spark from igniting tank fluids or dry cargo dust, the fine stainless steel flame screen arrests flames from crossing through this barrier. The ball float prevents contamination of tank cargo by sea water during heavy seas.

Purpose

The WAGER Vertical Vent Check Valve is used to protect tanks and bulkheads from vacuum pressure buildup during loading and unloading of liquid and dry cargo.

Description

The Vertical Vent Check Valve was designed to eliminate the need for a “goose neck” on deck for each valve. It is composed of an inner and outer valve body (cold galvanized), float (available in a variety of materials), stainless steel flame screen, and a steel cover.

Special Feature

The component design allows for easy disassembly, to allow cleaning of the venting chamber.

Features

Float (Standard) -
High Density Polyethylene

Float (Optional) -
Copper, Stainless Steel, Monel

Body Material - Steel
Optional — Stainless Steel

Cold Galvanized - Standard
Hot-Dip Galvanizing
(upon request)

Standard Sizes Available -
2, 2½, 3, 4, 5, 6, 8, 10 inches
(custom sizes available on request)

Connections -
Flanged, Butt Weld, Threaded

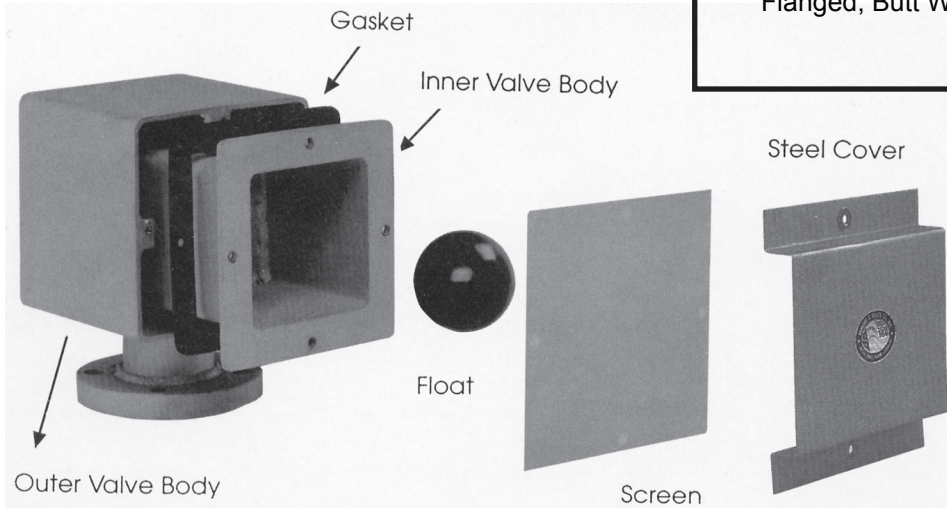



Deck Drains

Model 134 Series

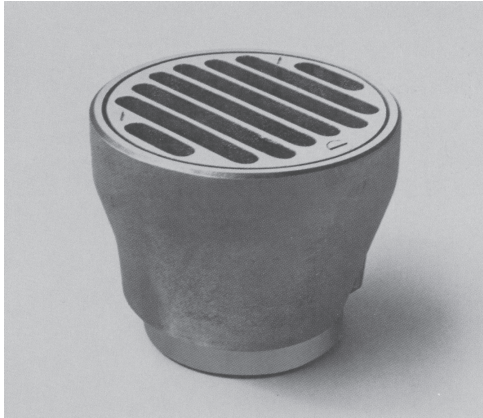

Heavy Wall Deck Drains

Cast steel body with cast bronze strainer and baffle. All Drains have a Ratio of 2:1 area through strainer to pipe size area.

Description: Wager Deck Drains are of economical commercial grade, consisting of a galvanized steel body and a bronze strainer plate that is removable, secured by three stainless steel flat head screws. The strainer plate has full openings to provide the desired drainage with pipe of minimum size.

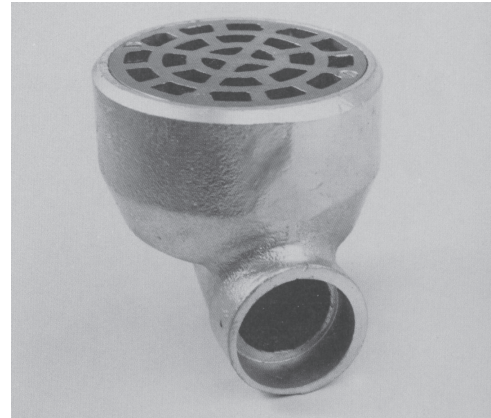

“IT’S NOT A WORD... IT’S A SENTENCE” (CONTINUED)

- “Before marriage, a man yearns for the woman he loves. After marriage, the ‘Y’ becomes silent.” -Anonymous
- “The poor wish to be rich, the rich wish to be happy, the single wish to be married, and the married wish to be dead.” -Ann Landers
- “Marriage teaches you loyalty, forbearance, self-restraint, meekness, and a great many other things you wouldn’t need if you had stayed single.” -Jimmy Townsend
- “Love is an ideal thing, marriage a real thing; a confusion of the real with the ideal never goes unpunished.” -Johann von Goethe
- “It’s a bit dangerous out there, and I guess men have to choose between marriage and death. I guess they figure that with marriage at least they get meals. But then they get married and find out we don’t cook anymore.” -Rita Rudner

DUPLEX INTAKE WATER STRAINER

**NEW
Item**

Available by
Oct. 2010

Figs. 0594 - Duplex Intake Water Strainer

Duplex strainers permit continuous engine operation by permitting strainer clean-out while the engine is running. Properly sized, a single side of the strainer will allow adequate flow for cooling. Using an integral valve, either side can be closed and cleaned without affecting coolant flow to the engine through the other side.

CONSTRUCTION:

- Cast Bronze
- 4-Position Control Valve (All Off/Side 1 On/Side 2 On/Both On)
- Many Replacement Parts in Common with Other Perko Strainers (Fig. 0493)

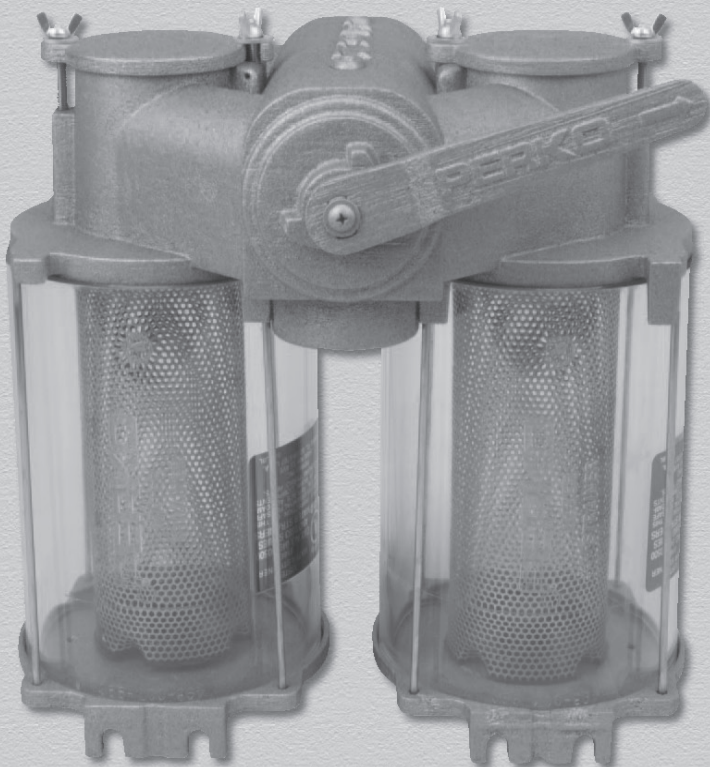
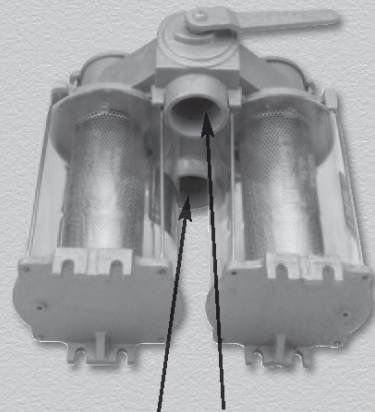

Fig. 0594

PERKO Duplex Water Strainers are Designed for Easy Installation and Cleaning. Features Include Mounting Lugs Cast into Both Sides to Assure Universal Mounting, 8 Outside Tie Rods and two 316 Stainless Steel Strainer Basket to Minimize Electrolysis. The diameter of the screen holes is 0.079" providing 47% open area, among the highest in the industry for cylindrical strainer baskets. Lugs for the Cast Bronze Covers Permit Easy Removal and Cleaning of the Strainer Baskets. Drain Plugs in the Bottom Castings are Provided for Easily Removing Sediment and Draining for Winterizing.



Pipe Connections

ORDERING & TECH INFO

Pipe Size Inches	Standard Pkg. - 1 Pc.	Height Overall Inches	Width Overall Inches	Depth Overall Inches	Dimensions Cylinder Inches O.D. x L	Open Area Dimensions Basket Inches	Each Side Open Area Ratio	Ship Wt. Carton Lbs. Std. Pkg.	Spare Gasket Kit* Dealer Pkg. - 5 Kts. 1 Kit. per Bag
1-1/2	0594008PLB	12	16	8-1/2	6 x 8	3-5/16 8-7/16	17:1	61	0594DP899R
2	0594009PLB	16	16	8-1/2	6 x 12	3-5/16 x 12-1/4	13:1	63	0594DP899R
2-1/2	0594010PLB	16	16	8-1/2	6 x 12	3-5/16 x 12-1/4	10:1	63	0594DP899R

DUPLEX INTAKE WATER STRAINER SPARE PARTS ORDERING INFORMATION

For Spare Part No. Insert a Spare Part Code Listed Below in Place of the "PLB" in the Strainer's Catalog Number (i.e., 059400699A, Top Casting for 1-1/2" (#8) Strainer).

Description	Spare Part Code	Sample Part Number	Package	Spare Part Description	Code	Sample Part Number	Package
Top Casting	.99A	059400899A	Boxed	Wing Nuts & Bolts for Cover	.99L	0493DP899L	Bag
Transparent Cylinder	.99C	049300899C	Boxed	Rubber Gasket Kit	Consists of:		
Basket Strainer Size 8	.99D	059400899D	Boxed	2 Cover Gaskets & 4 Body Gaskets	99R*	0594DP899R	Bag
Basket Strainer Sizes 9 & 10	.99D	049300999D	Boxed	Tie Rods	Consists of (4 Each for)		
Cover with Gasket	.99E	0049300899E	Boxed		.99P	0493DP899P	Bag

LIGHTWEIGHT INTAKE WATER STRAINER WITH CLEAR BODY

Fig. 0443 - Lightweight Intake Water Strainer

CONSTRUCTION:

- Cast Bronze with Clear Polymer Body
- Our Lightest Weight Strainer
- Many Replacement Parts in Common with Other Perko Strainers (Fig. 0493)

NEW Item

Available by
Oct. 2010

PERKO Water Strainers are Designed for Easy Installation and Cleaning. Features Include Mounting Lugs Cast into Both Sides to Assure Universal Mounting and a 316 Stainless Steel Strainer Basket to Minimize Electrolysis. The diameter of the screen holes is 0.079" providing 47% open area, among the highest in the industry for cylindrical strainer baskets. Hinged Lugs for the Cast Bronze Cover Permit Easy Removal and Cleaning of the Strainer Basket. A Drain Plug in the Bottom Casting is Provided for Easily Removing Sediment and Draining for Winterizing.

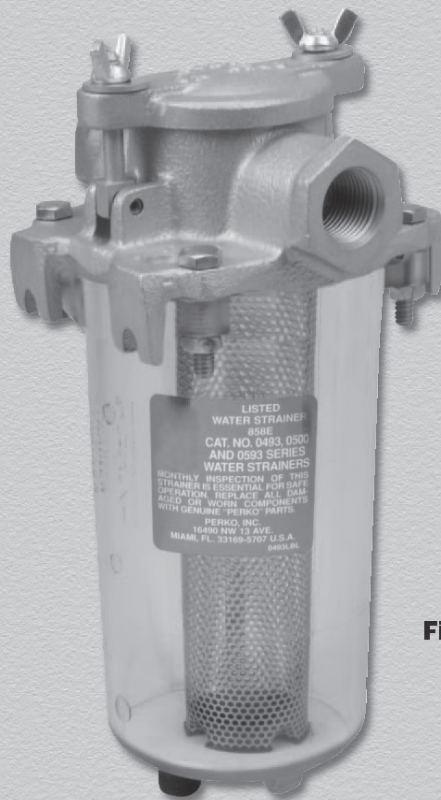
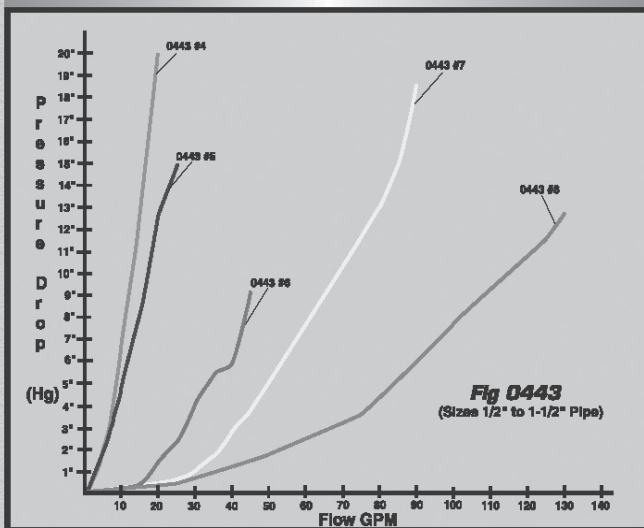

Fig. 0443

FIG. 0443 - DIFFERENTIAL PRESSURE GRAPH



ORDERING & TECH INFO

Pipe Size Inches	Standard Pkg. - 1 Pc.	Height Overall Inches	Width Overall Inches	Dimensions Cylinder Inches O.D. x L	Dimensions Basket Inches	Open Area To Pipe Size Ratio	Ship Wt. Carton Lbs. Std. Pkg.	Spare Gasket Kit* Dealer Pkg. - 5 Kts. 1 Kit. per Bag
1/2	0443004PLB	6-1/4	4-1/2	3-1/2 x 4-1/4	1-13/16 x 4-3/8	30:1	3.9	0443DP599R
3/4	0443005PLB	8-5/8	4-1/2	3-1/2 x 6-5/8	1-13/16 x 6-1/4	25:1	4.0	0443DP599R
1	0443006PLB	8-3/4	5-1/2	4-1/2 x 6	2-5/8 x 5-7/8	20:1	6.7	0443DP799R
1-1/4	0443007PLB	9-5/16	5-1/2	4-1/2 x 6-9/16	2-5/8 x 6-1/4	13:1	6.5	0443DP799R
1-1/2	0443008PLB	11-3/4	7-1/4	6 x 8-5/8	3-5/16 x 8-7/16	17:1	11.1	0443DP999R

CLEAR BODY INTAKE WATER STRAINER SPARE PARTS ORDERING INFORMATION

For Spare Part No. Insert a Spare Part Code Listed Below in Place of the "PLB" in the Strainer's Catalog Number (i.e., 049300699A, Top Casting for 1" (#6) Strainer).

Description	Spare Part Code	Sample Part Number	Package	Description	Spare Part Code	Sample Part Number	Package
Top Casting	.99A	049300499A	Boxed	Hinged Bolt for Cover			
Transparent Cylinder Body	.99C	044300499C	Boxed	With Pin, Nut and Washer	.99L	0493DP599L	Bag
Basket Strainer	.99D	049300499D	Boxed	Rubber Gasket Kit Consists of:			
Cover with Gasket	.99E	049300499E	Boxed	1 Cover Gasket & 1 Body Gasket	.99R*	0443DP599R	Bag
				Nuts and Washers Consists of:			
				4 Each for 0443 Series	.99F	0443DP499F	Bag

HEAVY DUTY 4" INTAKE WATER STRAINER

NEW
Item

Fig. 0693 - Intake Water Strainer

CONSTRUCTION:

- Cast Bronze

The new Perko Large Boat Strainer Line is designed for easy installation, cleaning and maintenance. Aircraft style mounting nuts hold fast without lock washers. They are held captive by the body and can't be dropped or lost. Once the mounting nuts are loosened, a convenient handle on the top cover allows it to be easily rotated and removed providing quick access to the strainer basket. Four 316 stainless steel tie rods and strainer basket minimize electrolysis. The diameter of the screen holes is 0.079" providing 47% open area, among the highest in the industry for cylindrical strainer baskets. A drain plug in the bottom casting is provided for easy sediment removal or to drain when winterizing. A transparent cylinder provides a visual check for debris.

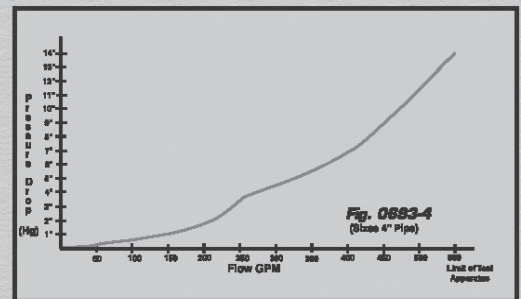
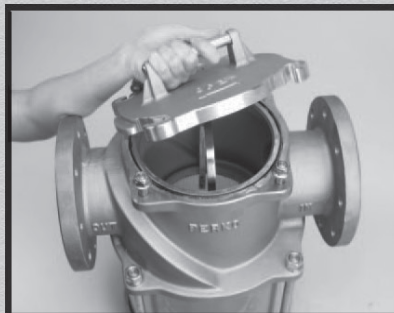
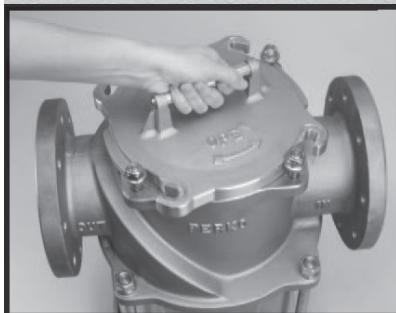
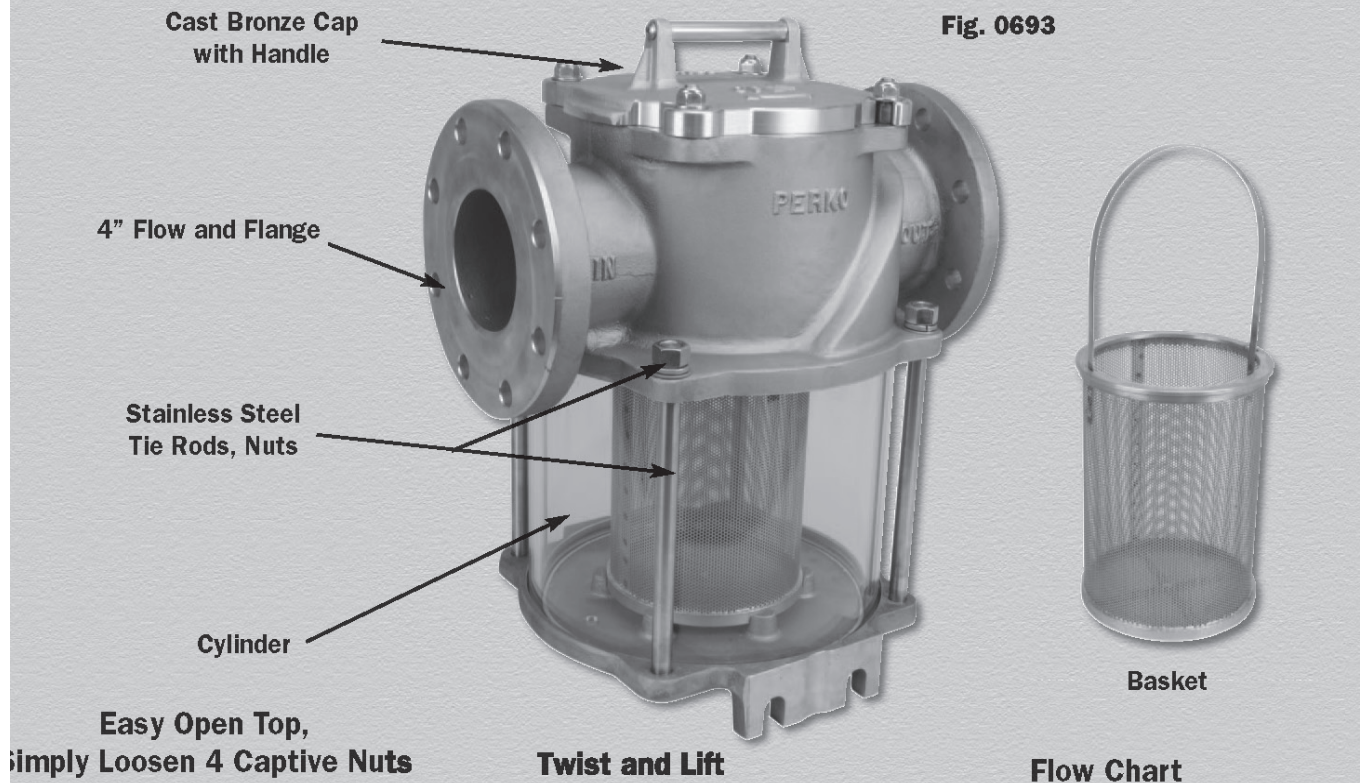

ORDERING & TECH INFO

Pipe Size Inches	Height Overall Inches	Width Overall Inches	Std. Pkg. 1 Pc.	Dimensions Cylinder Inches	Dimensions Basket Inches	Open Area To Pipe Size Ratio	Ship Wt. Carton Lbs. Std. Pkg.	Spare Gasket Kit* Std. Pkg. 1 Kit
4	17-1/2	16-1/2	0693012PLB	12 O.D. x 8-3/4	6-3/4 x 8-5/8	10:1	135.0	069301299R

*Spare Gasket Kit Consists of: 1 O-Ring for Cover and 2 Cylinder Gaskets

HEAVY DUTY 4" INTAKE WATER STRAINER SPARE PARTS

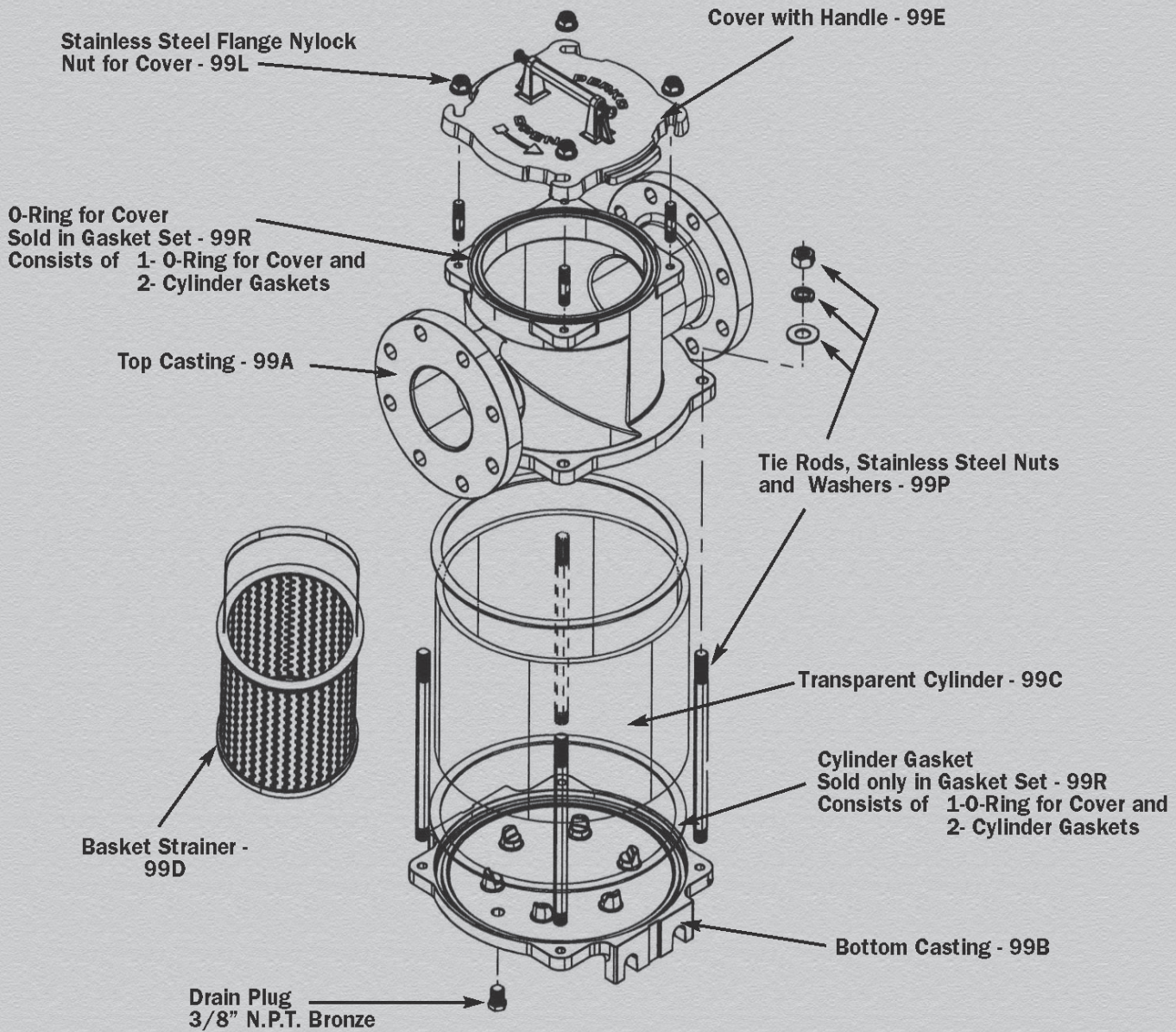

4" Intake Water Strainer Spare Parts Ordering Information

Description	Spare Part Code	Sample Part Number	Package	Description	Spare Part Code	Sample Part Number	Package
Top Casting	.99A	069301299A	Boxed	Gasket Kit Consists of: 1- Rubber O-Ring for Cover and 2- Rubber Cylinder Gaskets	.99R*	069301299R	Bag
Bottom Casting	.99B	069301299B	Boxed				
Transparent Cylinder	.99C	069301299C	Boxed	Tie Rods, Nuts and Washers Consists of (1 Each for 0693 Series)	99P	069301299P	Bag
Basket Strainer	.99D	069301299D	Boxed				
Cover with Handle	.99E	069301299E	Boxed				
Stainless Steel Flange Nylock Nut for Cover							
Nylock Nut & Stud for Cover	.99L	069301299L	Bag				

PERKO® INTAKE WATER STRAINERS

PERKO Water Strainers are Designed for Easy Installation and Cleaning. Features Include Mounting Lugs Cast into Both Sides to Assure Universal Mounting, Four Outside Tie Rods and a 316 Stainless Steel Strainer Basket to Minimize Electrolysis. The diameter of the screen holes is 0.079" providing 47% open area, among the highest in the industry for cylindrical strainer baskets. Hinged Lugs for the Cast Bronze Cover Permit Easy Removal and Cleaning of the Strainer Basket. A Drain Plug in the Bottom Casting is Provided for Easily Removing Sediment and Draining for Winterizing. For Applications Requiring Higher Capacity, Use Fig. 0500.

Figs. 0493 & 0500
Intake Water Strainers
CONSTRUCTION:

- Cast Bronze

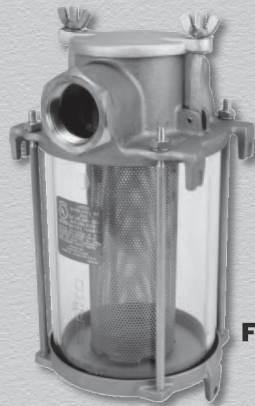

Fig. 0493



Fig. 0500



ORDERING & TECH INFO

Pipe Size Inches	Height Overall Inches	Width Overall Inches	Standard Pkg. - 1 Pc.	Dimensions Cylinder Inches O.D. x Height	Dimensions Basket Inches O.D. x Height	Open Area To Pipe Size Ratio	Ship Wt. Carton Lbs. Standard Pkg.	Spare Gasket Kit* Dealer Pkg. - 5 Kts. 1 Kit. per Bag
1/2	5-3/4	4-1/2	0493004PLB	3-1/2 x 4	1-13/16 x 4-3/8	30:1	4.9	0493DP599M (or) 99R
3/4	8-3/8	4-1/2	0493005PLB	3-1/2 x 6	1-13/16 x 6-1/4	25:1	5.0	0493DP599M (or) 99R
1	9-1/2	5-1/2	0493006PLB	4-1/2 x 5-1/2	2-5/8 x 5-7/8	20:1	8.1	0493DP799M (or) 99R
1-1/4	10	5-1/2	0493007PLB	4-1/2 x 6	2-5/8 x 6-1/4	13:1	7.9	0493DP799M (or) 99R
1-1/2	11-1/2	7-1/4	0493008PLB	6 x 8	3-5/16 x 8-7/16	17:1	13.7	0493DP999M (or) 99R
2	16	7-1/2	0493009PLB	6 x 12	3-5/16 x 12-1/4	13:1	19.5	0493DP999M (or) 99R
2-1/2	16	7-1/2	0493010PLB	6 x 12	3-5/16 x 12-1/2	10:1	18.0	0493DP999M (or) 99R

ORDERING & TECH INFO

Pipe Size Inches	Height Overall Inches	Width Overall Inches	Standard Pkg. - 1 Pc.	Dimensions Cylinder Inches O.D. x Height	Dimensions Basket O.D. x Height	Open Area To Pipe Size Ratio	Ship Wt. Carton Lbs. Standard Pkg.	Spare Gasket Kit* Standard Pkg. - 1 Kit
2	14-1/2	9	0500009PLB	8 x 10	3-7/8 x 10-1/4	20:1	36.0	0500DP999M (or) 99R
2-1/2	16-1/2	9	0500010PLB	8 x 12	3-7/8 x 12-1/4	18:1	33.5	0500DP999M (or) 99R
3	18-1/2	9	0500011PLB	8 x 14	3-7/8 x 14-1/4	14:1	34.0	0500DP999M (or) 99R

*Spare Gasket Kit Consists of: 1 Cover Gasket and 2 Cylinder Gaskets

INTAKE WATER STRAINER & FLUSHING STRAINER SPARE PARTS ORDERING INFORMATION

For Spare Part No. Insert a Spare Part Code Listed Below in Place of the "PLB" in the Strainer's Catalog Number (i.e., 049300699A, Top Casting for 1" (#6) Strainer).

Description	Spare Part Code	Sample Part Number	Package	Description	Spare Part Code	Sample Part Number	Package
Top Casting	.99A	049300499A	Boxed	Cork Gasket Kit Consists of: 1- Cover Gasket and 2- Cork Cylinder Gaskets	.99M*	0493DP599M	Bag
Bottom Casting	.99B	049300499B	Boxed		Rubber Gasket Kit Consists of: 1- Cover Gasket and 2- Rubber Cylinder Gaskets	.99R*	0493DP599R
Transparent Cylinder	.99C	049300499C	Boxed	Tie Rods, Nuts and Washers Consists of (4 Each for 0493 Series) (1 Each for 0500 Series)		.99P	0493DP499P
Basket Strainer	.99D	049300499D	Boxed				
Cover with Gasket	.99E	049300499E	Boxed				
Hinged Bolt for Cover							
With Pin, Nut and Washer	.99L	0493DP599L	Bag				
Cork Cover Gasket Kit (Set of 2)	.99N	0493DP599N	Bag				

* Note: Older model strainers utilizing cork cylinder gaskets must order 99M Cork Gasket Kit and newer model strainers must order 99R Rubber Gasket Kit.

INTAKE & FLUSHING WATER STRAINERS SPARE PARTS

Figs. 0493 & 0500 - Intake Water Strainers and Fig. 0593 Flushing Strainer Spare Parts Ordering Information

Fig. 0593 Flushing Strainer

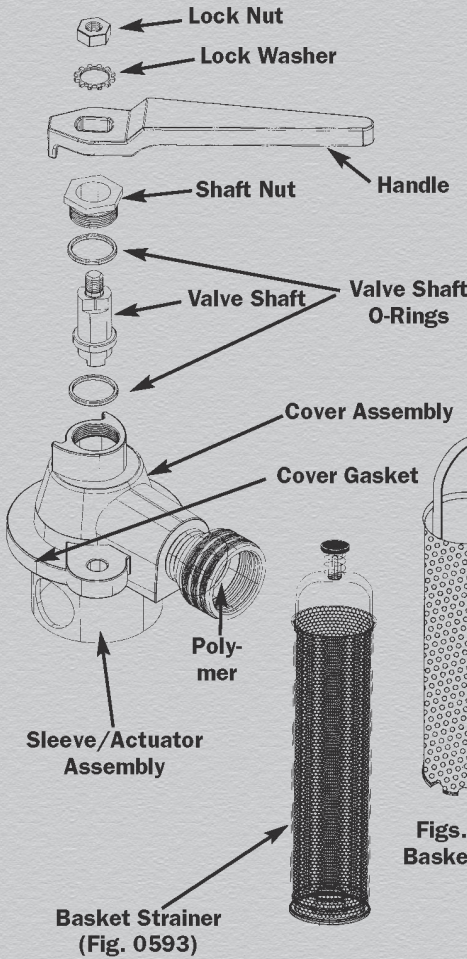

Figs. 0493 & 0500 Intake Strainer

Hinged Bolt for Cover with Pin, Nut and Washers - 99L

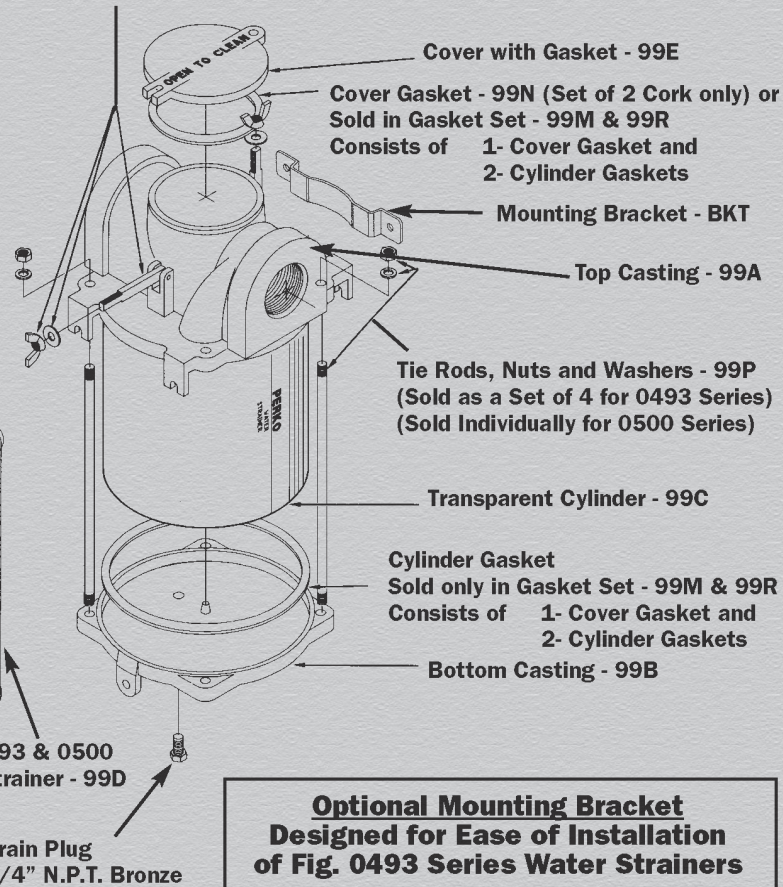

Optional Mounting Bracket Designed for Ease of Installation of Fig. 0493 Series Water Strainers



Part Number	Fits Strainer Size
0493045BKT	4 & 5
0493067BKT	6 & 7
0493089BKT	8 & 9

FIGS. 0493 & 0593 - DIFFERENTIAL PRESSURE GRAPHS

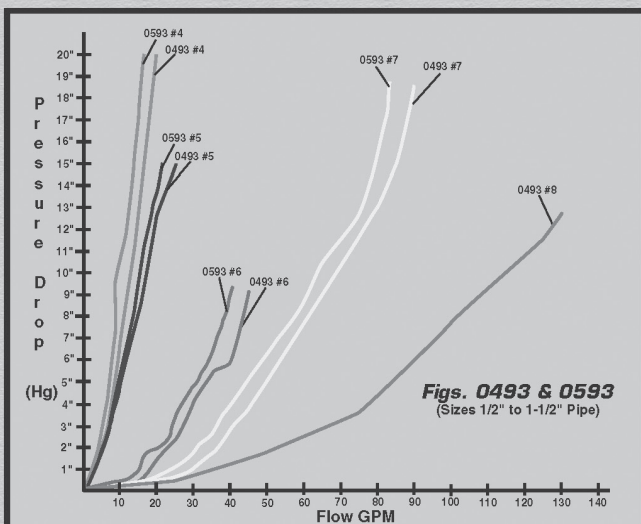

FIGS. 0493 & 0500 - DIFFERENTIAL PRESSURE GRAPHS

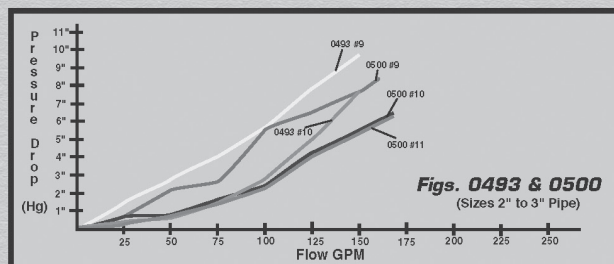

PERKO® FLUSHING STRAINER

PERKO Flushing Strainers are Designed for Easy Installation and Cleaning. Features Include Mounting Lugs Cast into Both Sides to Assure Universal Mounting, Four Outside Tie Rods and a 316 Stainless Steel Strainer Basket to Minimize Electrolysis. The diameter of the screen holes is 0.079" providing 47% open area, among the highest in the industry for cylindrical strainer baskets. Hinged Lugs for the Cast Bronze Cover Permit Easy Removal and Cleaning of the Strainer Basket. A Drain Plug in the Bottom Casting is Provided for Easily Removing Sediment and Draining for Winterizing.

Fig. 0593 - Flushing Strainer Fresh Water Flushes your Inboard or Generator Simply and Easily

CONSTRUCTION:

- Cast Bronze
- Available in 1/2", 3/4", 1", or 1-1/4" Pipe Sizes
- Uses Standard Perko Strainer Replacement Parts (Gaskets, Cylinders, Nuts and Tie Rods)
 - Handle Indicates Flow Direction
- Top Casting Removes Easily for Basket Cleaning
 - Reversible Bulkhead Mounting Option
 - Smooth Acting, Low Torque Ball Valve
- Internal Cam Seals Fresh Water Intake During Normal (Through Strainer) Operation
- Can Act as an Emergency Bilge Pump



Fig. 0593

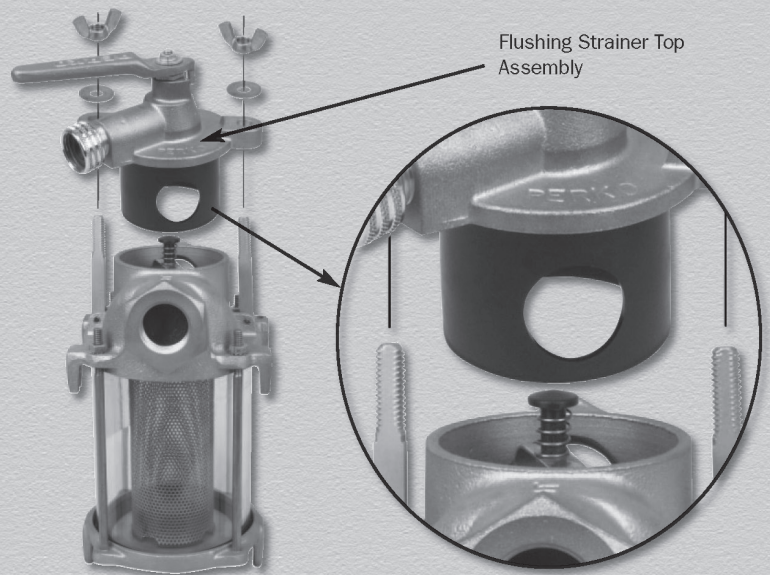

ORDERING & TECH INFO

Pipe Size Inches	Height Overall Inches	Width Overall Inches	Standard Pkg. - 1 Pc.	Dimensions Cylinder Inches	Dimensions Basket Inches	Open Area To Pipe Size Ratio	Weight Pounds	Spare Gasket Kit* Dealer Pkg. - 5 Kts. 1 Kit per Bag
1/2	5-3/4	4-1/2	0593004PLB	3-1/2 x 4	1-13/16 x 4-3/8	30:1	5.9	0493DP599R
3/4	8-3/8	4-1/2	0593005PLB	3-1/2 x 6	1-13/16 x 6-1/4	25:1	6.2	0493DP599R
1	9-1/2	5-1/2	0593006PLB	4-1/2 x 5-1/2	2-5/8 x 5-7/8	20:1	9.1	0493DP799R
1-1/4	10	5-1/2	0593007PLB	4-1/2 x 6	2-5/8 x 6-1/4	13:1	9.1	0493DP799R

Flushing Strainer Spare Parts Ordering Information							
Description	Spare Part Code	Sample Part Number	Package	Description	Spare Part Code	Sample Part Number	Package
Handle (Fig. 0805)	99D	080500599D**	Boxed	Sleeve Assy.	99B	059300499B	Boxed
Valve Shaft	99A	059300499A	Boxed	Cover Assy.	99C	059300499C	Boxed

See Pages 146-147 For Additional Spare Parts Ordering Information and Differential Pressure Graphs.

*Spare Gasket Kit Consists of: 1 Cover Gasket and 2 Cylinder Gaskets.

** For Complete Handle Part Numbers See Fig. 0805 on page 154.